

# GUILDHALL

SALES & LETTINGS



## 147 Skeffington Road

, Preston, PR1 5HD

£100,000



**\*\*TWO BEDROOMED MID-TERRACED PROPERTY\*\***

Guildhall Sales and Lettings are delighted to introduce this two bedroomed mid-terraced property to the market. Situated in Preston, within close proximity to local amenities, commuter links and schools. Boasting spacious accommodation throughout, this property is well suited for first time buyers or investors and internally comprises briefly:

Entrance through to the lounge providing access to the fitted kitchen housing the staircase to the first floor and a door to the rear. To the first floor are two bedrooms and a three piece family bathroom suite.

Externally to the rear is an enclosed rear yard.

Viewings are essential, for further information or to arrange a viewing, please call the team on 01772 769999.



## Ground Floor

Lounge 12'9" x 14'2" (3.89 x 4.33)

Kitchen 12'9" x 9'7" (3.89 x 2.94)

## First Floor

Bedroom One 12'9" x 12'7" (3.89 x 3.86)

Bedroom Two 9'4" x 9'8" (2.84m x 2.95m)

Bathroom 8'1" x 6'6" (2.47 x 1.99)

## Area Map

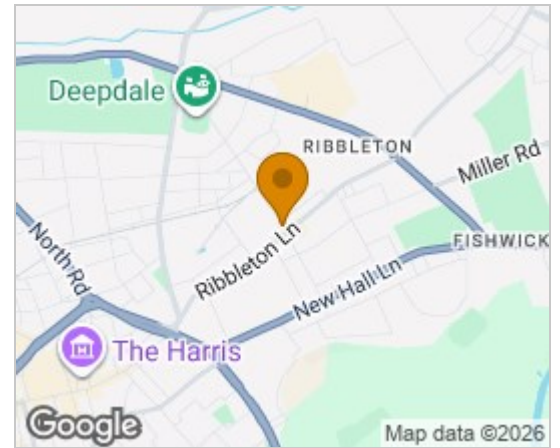

## Floor Plans

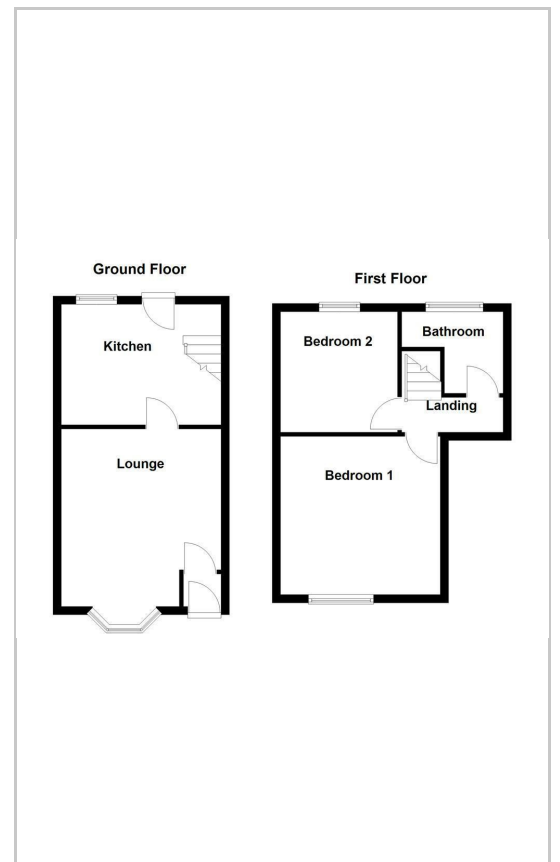

## Energy Efficiency Graph

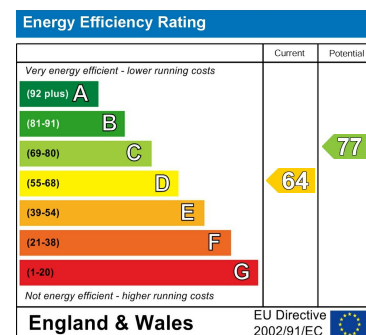

These particulars, whilst believed to be accurate are set out as a general outline only for guidance and do not constitute any part of an offer or contract. Intending purchasers should not rely on them as statements of representation of fact, but must satisfy themselves by inspection or otherwise as to their accuracy. No person in this firm's employment has the authority to make or give any representation or warranty in respect of the property.

441 Blackpool Road, Preston, PR2 2LE

Tel: 01772769999 Email: <https://guildhalllettings.co.uk/>